

GAZELLE®

GC2044 Cordless Brushless Blower User Manual



• Pictures of battery packs with different configurations vary in the illustration.

EN

Read through carefully and understand these instructions before use.

Original instructions

General safety warnings



This appliance is not intended for use by persons (including children) with reduced physical, sensory or mental capabilities, or lack of experience and knowledge, unless they have been given supervision or instruction concerning use of the appliance by a person responsible for their safety. Children should be supervised to ensure that they do not play with the appliance.

IMPORTANT

READ CAREFULLY BEFORE USE.

KEEP FOR FUTURE REFERENCE.

Safe operating practices for hand-held battery-operated electrical garden vacuums, and garden blower/vacuums with or without shredding means and garden blowers

1 Training

- a) Read the instructions carefully. Be familiar with the controls and the correct use of the machine.
- b) Never allow children or people unfamiliar with these instructions to use the machine. Local regulations can restrict the age of the operator.
- c) Keep in mind, that the operator or user is responsible for accidents or hazards occurring to other people or their property.

2 Preparation

- a) Obtain ear protection and safety glasses. Wear them at all times while operating the machine.
- b) While operating the machine always wear substantial footwear and long trousers. Do not operate the machine when barefoot or wearing open sandals. Avoid wearing clothing that is loose fitting or that has hanging cords or ties.
- c) Do not wear loose clothing or jewellery that can be drawn into the air inlet. Keep long hair away from the air inlets.
- d) Operate the machine in a recommended position and only on a firm, level surface.
- e) Do not operate the machine on a paved or gravel surface where ejected material could cause injury.
- f) Before using, always visually inspect to see, that the shredding means, shredding means bolts and other fasteners are secure, the housing is undamaged and that guards and screens are in place. Replace worn or damaged components in sets to preserve balance. Replace damaged or unreadable labels.
- g) Never operate the machine while people, especially children, or pets are nearby.

3. Operation

- a) Before starting the machine, make certain that the

feeding chamber is empty.

- b) Keep your face and body away from the feed intake opening.
- c) Do not allow hands or any other part of the body or clothing inside the feeding chamber, discharge chute, or near any moving part.
- d) Keep proper balance and footing at all times. Do not overreach. Never stand at a higher level than the base of the machine when feeding material into it.
- e) Always stand clear of the discharge zone when operating this machine.
- f) When feeding material into the machine be extremely careful that pieces of metal, rocks, bottles, cans or other foreign objects are not included.
- g) if the machine should start making any unusual noise or vibration, immediately shut off the power source and allow the machine to stop. Remove battery pack from the machine and take the following steps before restarting and operating the machine: i) inspect for damage;
ii) replace or repair any damaged parts;
iii) check for and tighten any loose parts.
- h) Do not allow processed material to build up in the discharge zone; this may prevent proper discharge and can result in kickback of material through the intake opening.
- i) If the machine becomes clogged, shut-off the power source and remove battery pack from the machine before cleaning debris.
- j) Never operate the machine with defective guards or shields, or without safety devices, for example debris collector in place.
- k) Keep the power source clean of debris and other accumulations to prevent damage to the power source or possible fire.
- l) Do not transport this machine while the power source is running.
- m) Stop the machine, and remove battery pack from the machine. Make sure that all moving parts have come to a complete stop
- whenever you leave the machine,
- before clearing blockages or unlogging chute,
- before checking, cleaning or working on the machine.
- n) Do not tilt the machine while the power source is running.

4. Maintenance and storage

- a) When the machine is stopped for servicing, inspection, or storage, or to change an accessory, shut off the power source, remove battery pack from the machine and make sure that all moving parts are come to a complete stop. Allow the machine to cool before making any inspections, adjustments, etc. Maintain the machine with care and keep it clean.

- b) Store the machine in a dry place out of the reach of children.
- c) Always allow the machine to cool before storing.
- d) Replace worn or damaged parts for safety. Use only genuine replacement parts and accessories.
- e) Never attempt to override the interlocked feature of the guard.

5. Additional safety instructions for units with bagging attachments

Switch-off the machine before attaching or removing the bag.

Battery safety warning

- a) Do not dismantle, open or shred secondary cells or batteries.
- b) Keep batteries out of the reach of children. Battery usage by children should be supervised. Especially keep small batteries out of reach of small children.
- c) Do not expose cells or batteries to heat or fire. Avoid storage in direct sunlight.
- d) Do not short-circuit a cell or a battery. Do not store cells or batteries haphazardly in a box or drawer where they may short-circuit each other or be short-circuited by other metal objects.
- e) Do not subject cells or batteries to mechanical shock.
- f) In the event of a cell leaking, do not allow the liquid to come in contact with the skin or eyes. If contact has been made, wash the affected area with copious amounts of water and seek medical advice.
- g) Do not use any charger other than that specifically provided for use with the equipment.
- h) Do not use any cell or battery which is not designed for use with the equipment.
- i) Do not mix cells of different manufacture, capacity, size or type within a device.
- j) Always purchase the battery recommended by the device manufacturer for the equipment.
- k) Keep cells and batteries clean and dry.
- l) Wipe the cell or battery terminals with a clean dry cloth if they become dirty.
- m) Secondary cells and batteries need to be charged before use. Always use the correct charger and refer to the manufacturer's instructions or equipment manual for proper charging instructions.
- n) Do not leave a battery on prolonged charge when not in use.
- o) After extended periods of storage, it may be necessary to charge and discharge the cells or batteries several times to obtain maximum performance.
- p) Retain the original product literature for future reference.
- q) Use the cell or battery only in the application for which it was intended.
- r) When possible, remove the battery from the equipment when not in use.

- s) Keep the cell or battery away from microwaves and high pressure.
- t) Dispose of properly.

Symbol



Read operator's manual



Do not expose to rain



Wear eye protection



Keep bystanders away



Do not burn



Do not charge a damaged battery pack



Li-Ion



Do not dispose of batteries. Return exhausted batteries to your local collection or recycling point.

Usage and specification

Model		GC2044
Recommended Battery V==		20
Battery	Kinds	Li-Ion
Speed	1 Files /min	11000
	2 Files /min	15000
	3 Files /min	18000
Air Volume	1 Files m ³ /min	1.9
	2 Files m ³ /min	2.6
	3 Files m ³ /min	3.11
Net weight (Without battery) (kg)		1.3

IMPORTANT INSTRUCTIONS FOR BATTERY & CHARGER

- Before doing any work (such as tool change, inspection, maintenance, handling, storage, etc.), it is necessary to place the positive and negative slide in the central position (switch lock) and remove the battery pack.
- Before using the machine, you must check whether the battery pack is properly installed.
- It's normal that the battery and charger will become warmer while in charging.
- Do not charge for damaged battery.
- When charging finished, unplug the charger firstly and then remove the battery from the charger. Do not leave the battery in the charger for long time.
- Do not put the battery in the charger when the tool is not in use.
- Do not attempt to disassemble the battery pack. When it needs maintenance or repair, hand it over to a professional repairman. Improper assembly can be a danger of electric shock or fire.
- Do not use short connect the battery pack.
- Do not incinerate the battery; it can explode in a fire.
- Do not drop, vibrate or hit the battery pack.
- Do not use the battery pack as a hammer. Striking the battery pack can cause an accidental short-circuit, fire, or explosion.
- Keep battery far from fire and high temperature, **THERE IS A DANGER OF EXPLOSION!** Never place battery on radiator or expose it under continuous sun irradiation, it may be damaged by overheated.
- Good ventilation must be ensured in the workplace. Toxic gases emitted by battery packs that are not used in accordance with regulations or damaged may cause personal injury. Keep battery far from fire and high temperature, **THERE IS A DANGER OF EXPLOSION!** Never place battery on radiator or expose it under continuous sun irradiation, it may be damaged by overheated.
- Overheating or overusing of the battery may cause liquid escape and come into contact with the adjacent components. Clean such parts or replace them, if required. If electrolyte contacts with your skin, wash the contacted area with soap firstly and then wash with lemon juice and vinegar. If electrolyte gets into your eyes, rinse them out with clear water and seek medical attention right away.
- If the life of the battery pack is significantly shortened after each charge, please replace the battery pack with a new one or go to the maintenance site to check.
- The battery pack should be moisture-proof and mildew proof. Do not touch water or rain.
- Please store the battery pack fully charged.
- The battery pack is stored in an ambient temperature range of 0-45°C. The battery pack capacity will be affected if the ambient temperature is too high or too low when the battery pack is stored.
- Avoid placing the battery pack near other metal objects such as paper clips, coins, keys, nails, screws, or other small metal objects that may cause the battery pack contacts to join together. When the battery pack contacts short circuit, it can cause sparks, burns, or fire.
- Do not dispose of discarded battery packs in general household trash, fire or water.
- Please collect damaged battery packs and send them to a recycling center or dispose of them in an environmentally friendly manner.
- Do not charge the battery pack when the room temperature is lower than 5°C or higher than 40°C; it may not be possible to charge when the room temperature is below 0°C.

SAVE THESE INSTRUCTIONS.
GENERAL DESCRIPTIONS

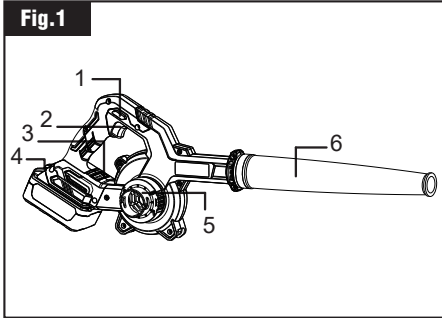

- 1.Lock Switch
- 2.Switch Trigger
- 3.Speed Governing
- 4.Battery Pack Button
- 5.Dust Absorption Connector
- 6.Blowpipe

INSTRUCTIONS FOR OPERATION

The battery pack is only partially charged upon delivery. In order to ensure the maximum power of the battery, the battery pack must be fully charged in the charger before the first use.

Install or remove the battery pack

* Note: Only specific battery packs can be used. The use of battery packs of other brands carries the risk of injury, personal injury and property damage due to battery pack explosion.

As shown in the figure below, when inserting the battery pack, pay attention to insert the battery pack correctly into the case. Please be sure to insert it until you hear the "click" sound, indicating that the battery pack is firmly attached to the machine. Otherwise, the battery pack could accidentally fall out of the casing, causing injury to the operator or others. Avoid plugging the battery pack too hard or knocking it in with the aid of other objects.

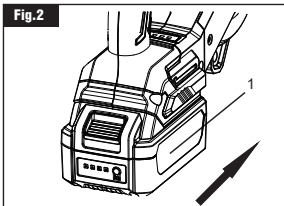

- 1.Battery Pack

Install battery pack

The battery package is placed under the machine handle, press the battery pack button, and then pull

the battery pack out.

CAUTION: Don't pull out the battery constantly!

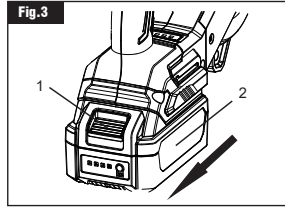

- 1. Battery Pack Button
- 2. Battery Pack

Battery Indicator Light

When the power button or startup tool is pressed, the power indicator will show the battery pack's power, which can be measured by four LED light. (Hereinafter referred to as red light) status to display.

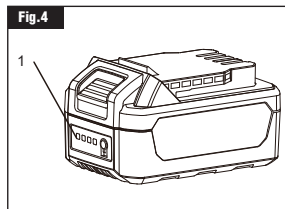

- 1. Battery Indicator Light

Power status is shown in the table below

Red state	Approximate remaining power
4 red light kept on	75%~100%
3 red light kept on	50%~75%
2 red light kept on	25%~50%
1 red light kept on	10%~25%

• Continuous use

After continuous use of the machine until the battery is exhausted, cool the machine for 15 minutes before changing the battery pack to continue use.

• Overdischarge protection

The machine is equipped with over-discharge protection circuit, when the battery power is low, the protection circuit will open, and the machine will stop running.

• Disposal of discarded battery packs

To protect natural resources, properly recycle or dispose of battery packs. The battery contains a lithium battery. Please consult your local authority for information on recycling and/or disposal. Remove the battery pack when it has run out of power and wrap the pole port with strong tape to avoid short circuit and leakage. Do not attempt to open or remove any component.

Directions for use:

As shown in the following figure, when installing the air duct, install the air duct to the blow outlet of the hair dryer, and rotate toward the mark  to the end to complete the installation;

To complete the disassembly, turn the mark  to the end and pull it out.

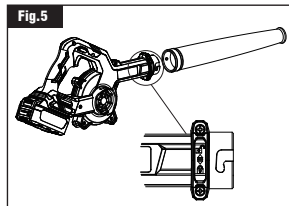

• Operation of switches

To start the machine, just press the switch button. The machine stops when the switch button is released.

Note: Before inserting the battery pack into the machine, please be sure to check whether the switch button works properly and whether it can return to the off position after release.

• Operation of speed regulating button

The machine has three speeds, which can be realized by pressing the speed regulating button; Press once to achieve a speed control action, you can view the current gear through the corresponding number of the indicator light on the speed control panel.

• Lock switch operation

After the switch button is pressed to the end, hold it down and then push the lock switch left or right, and then release the switch; The machine can operate sustainably without pressing the switch all the time by hand.

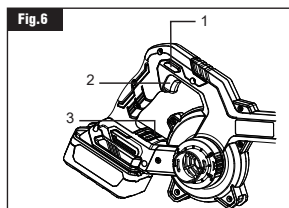

- 1.Locking Switch
- 2.Switch Trigger
- 3.Speed Governing Button

• Dust suction operation

When vacuum operation is needed, the air duct should be aligned with the suction interface. Then rotate toward the mark to the end, and then align the dust suction interface with the dust suction port of the whole machine and rotate in the same direction; Finally, install the dust bag to

Blow the outlet can be blown.

* Note: As the motor is magnetic, the machine can not be used to suck metal powder and other impurities, otherwise it will cause damage to the motor.

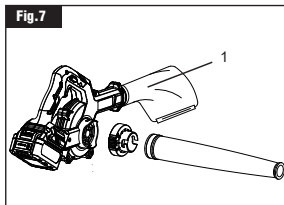

1.Dust Bag

Check mounting screw

Dust removal operations should be checked frequently

After the dust is filled, untie the closing strip and pour out the contents of the dust bag.

* Note: In order to prevent dust irritation during operation, you must wear goggles and masks.

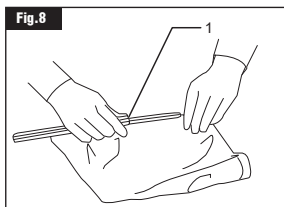

1.Close Up Strip

Maintenance and maintenance

Deposit:

When do not need to use the machine for a long time, please pull out the battery pack. The battery packages exist away from the metal objects, such as paper clips, COINS, keys, nails, screws, or other small metal objects, etc. These objects may be the battery's two terminals together. The short answer the battery terminals may cause fire or explosion.

Clean up the air vents:

The vents must be kept clean of the machine. Should be regular cleaning or clear congestion occurs at any time. Check the mounting screw Should always check whether mounting screw fastening safely. If found loose screws, shall be immediately to tighten, so as to avoid an accident.

Clean:

Banning the use of liquid such as water or chemical cleaning agent to clean the machine, with a dry cloth to wipe clean, keep the handles dry, clean, avoid the

pollution of oil grease.

In order to guarantee the safety and reliability of the product, please send your power tools to the service center for repair of the company

Standard accessories*

note:

figure and table or instructions shown on the attachment, not all included in the scope of supply.

Dust bag assembly

Blowpipe

Battery pack

The charger

Malfunction	Analyze	Solution
Machine not working, battery intact and fully charged	Bad contact between battery pack and machine	Reinstall the battery pack.
	Machine parts damaged	Return the machine to the original factory or repair site for repair.
The machine stopped working suddenly	The battery pack is exhausted.	Recharge the battery pack or replace the fully charged battery pack.
	High temperature or overload protection	Leave the machine and battery pack to cool down.
	Machine parts damaged	Return the machine to the original factory or service site for repair.
Excessive machine noise and high temperature	Machines absorb dust or iron filings	Clean the machine.
	Machine parts damaged	Return the machine to the original factory or repair site for repair.

MAINTENANCE AND INSPECTION

INSPECTION

If the machine passes the regular inspection, the "qualified" mark should be pasted on the appropriate part of the machine. The "conformity" mark shall be distinct, clear and correct and shall at least include: machine number, name or mark of inspection unit, name or mark of inspection personnel, and date of validity.

When the machine is sent out or taken back, the custodian must make a routine inspection. Before use, the user must carry out a routine inspection of the machine

Bad places should also be correspondingly shortened inspection cycle, in the plum rain season should be timely inspection. The unit that uses must have full-time personnel to carry out regular inspection; Check at least once a year; In hot and humid areas with frequent temperature variations or in poor service conditions

Maintenance

The maintenance of the machine must be carried out by a maintenance unit approved by the original production unit. The user and the maintenance department shall not modify the original design parameters of the machine at will, and shall not use substitute materials that are lower than the performance of raw materials and parts and components that do not conform to the original specifications.

For battery tools:

Ambient temperature range during operation and storage: 0°C - 45°C .

Recommended ambient temperature range during charging: 5°C - 40°C .

	Charger	Battery Pack
Model	GC1001	GC1040

*The battery packs of our company are constantly updated, please look forward to our service and latest news!

EXPLANATION OF GENERAL VIEW

1	Blowpipe	12	Spring 0.6*6.7*26
2	Blowpipe Steel Band	13	Locking Switch
3	Cross Recessed Pan Head Tapping Screw St3.5×16ST3.5×16	14	Rubber Pin
4	Left End Cover	15	Right Motor Housing
5	Filter sponge	16	Right End Cover
6	Cross Recessed Pan Head Tapping Screw(With Spring And Flat Washer)	17	Cleaner Interface
7	Left Motor Housing	18	Controller assembly
8	Motor Assembly	19	Battery socket
9	Bearing	20	20V Battery Pack Assembly
10	Torque Setting Panel	21	20V Charge Assembly
11	Switch	22	Dust Bag Assembly

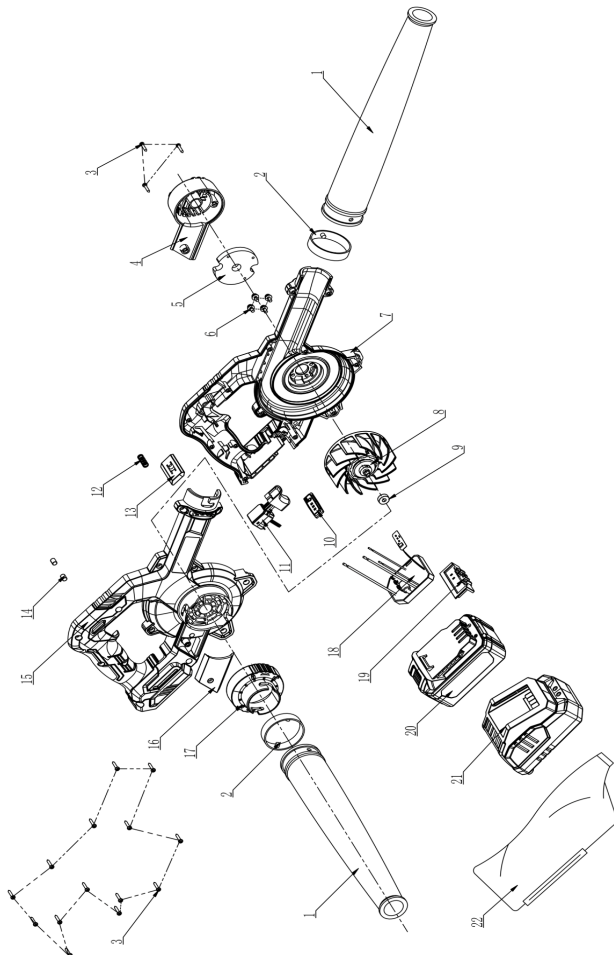

INNOVATION
PERFORMANCE
SAFETY
CONFIDENCE
GAZELLE

GAZELLE

sales@gazelleindustrial.com | www.gazelleindustrial.com