

# BT508/BT510/BT520/BT521 Battery Analyzer

Quick Reference Guide / 快速参考指南

⚠ Warning / 警告

To prevent possible electrical shock, fire, or personal injury, read the "BT508/BT510/BT520/BT521 Safety Sheet" before you use this Product.

为了防止可能发生的电击、火灾或人身伤害，使用本产品前请阅读《BT508/BT510/BT520/BT521 安全说明书》。

Go to [www.fluke.com](http://www.fluke.com) to register your product, download manuals, and find more information

请至 [www.fluke.com](http://www.fluke.com) 注册您的产品、下载手册，并获取更多信息。

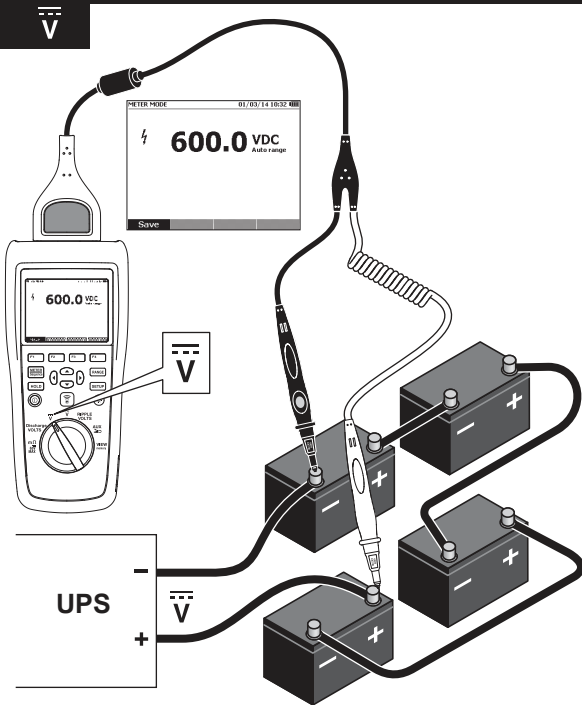

## AUX Current / 辅助电流

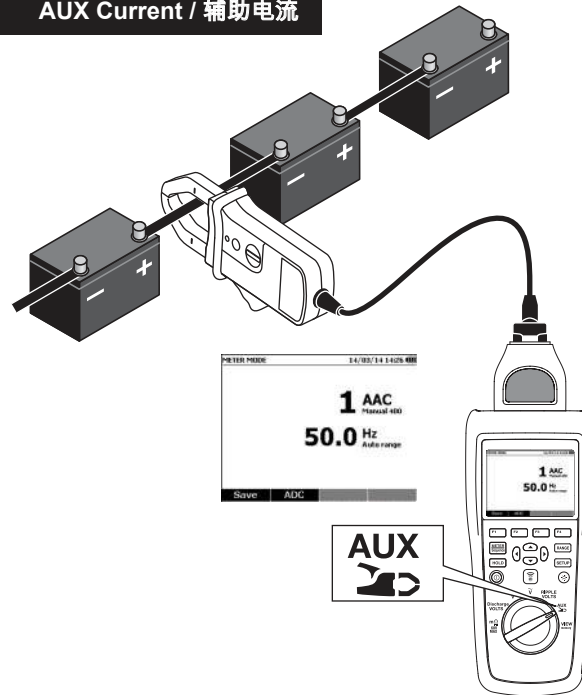

## Mobile Apps (BT521 Only) / 移动设备 (仅限BT521)

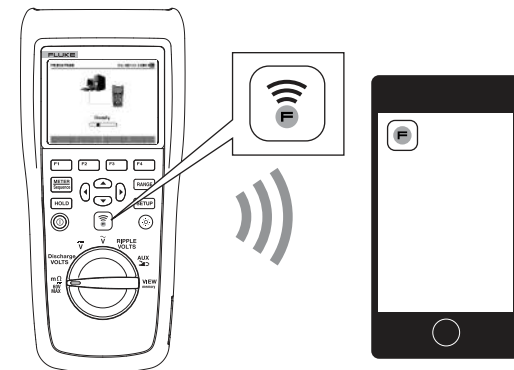

## TL175 Operation / TL175 操作

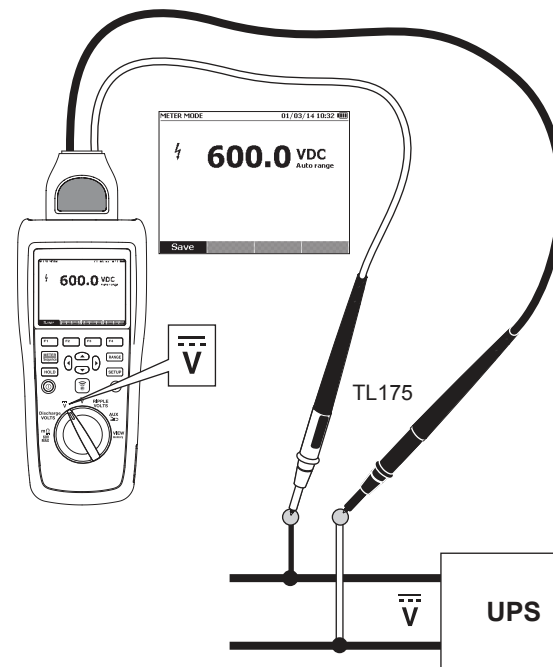

## mΩ / Discharge Volts / Ripple Volts / 内阻 / 放电电压 / 纹波电压

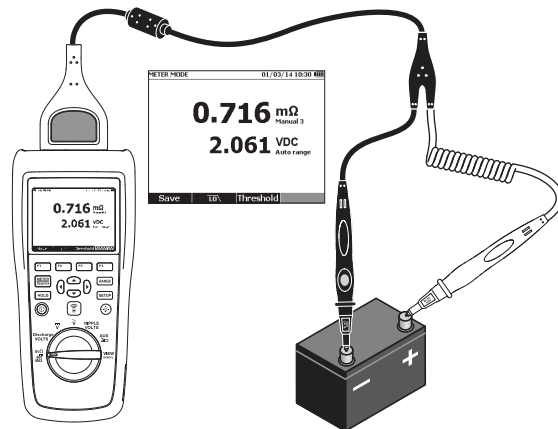

## Connect Test Probes / 连接测试探针

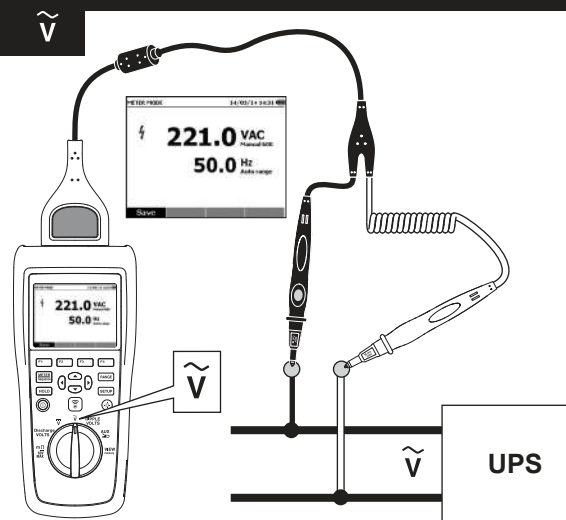
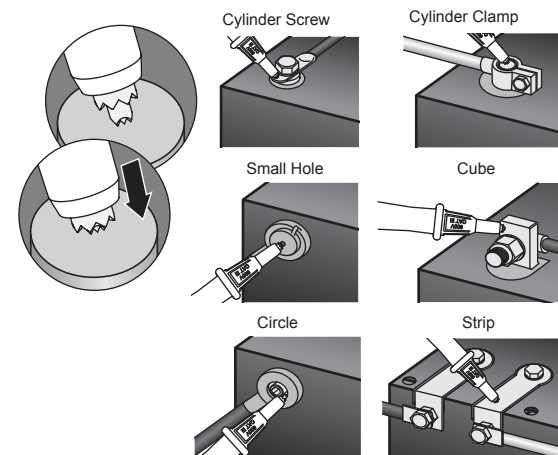

**View Memory / 查看存储**

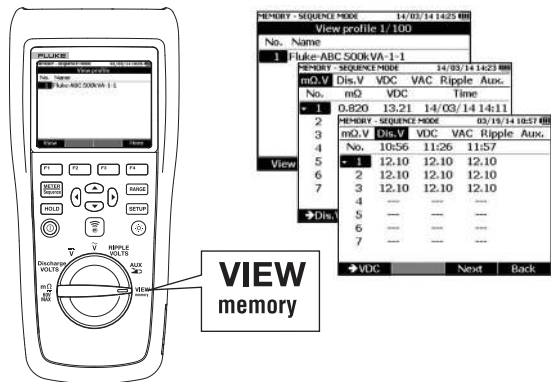

**Save / 保存**

**Manual Save / 手动保存**

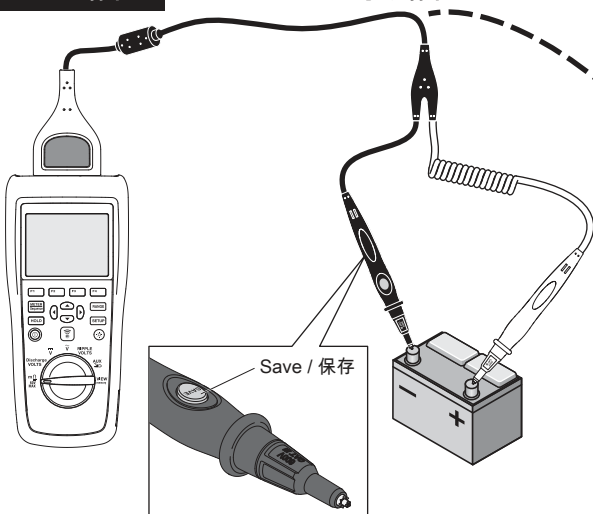

**Enable Auto Save in Setup Menu / 可在设置菜单里启用自动保存。**

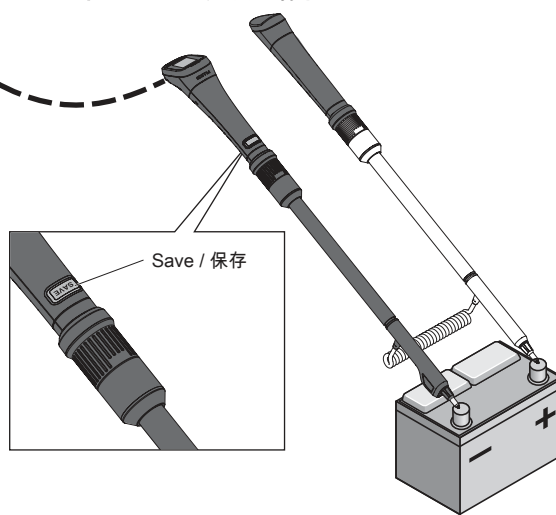

**Replace Test Tip / 更换测试探头**

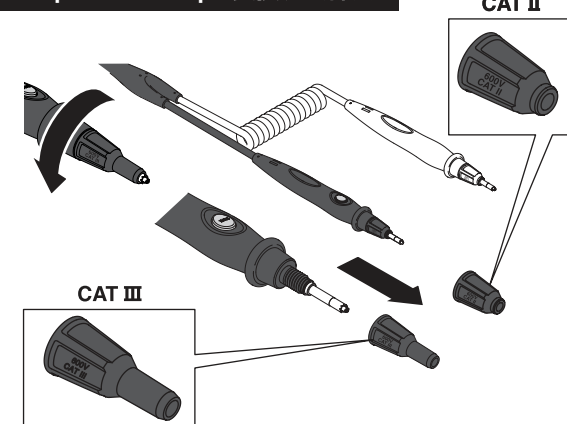

**Temperature (BT521 Only) / 温度 (仅限BT521)**

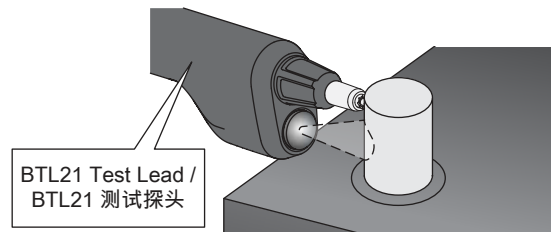

**Meter / Sequence / 切换到Meter 模式 / 切换到Sequence 模式**

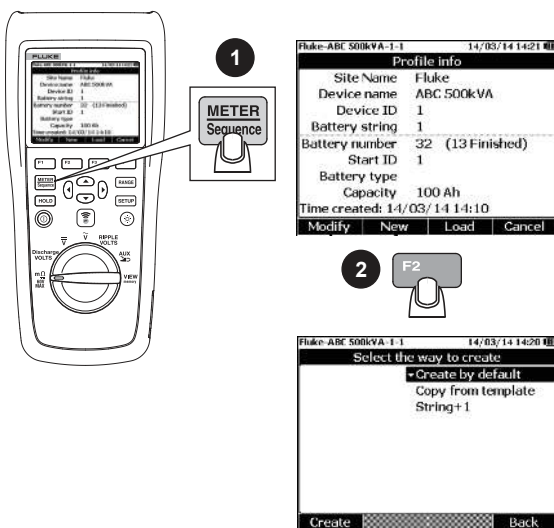

**Calibration ("0-Ohm") / 校准 (0-Ohm)**

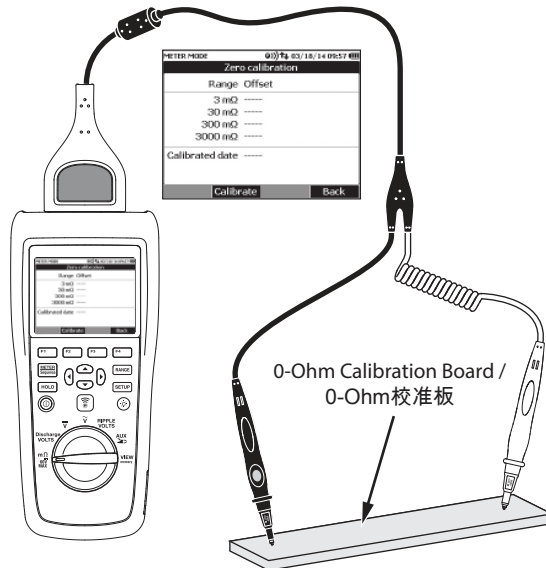

**Upload / Download Data / 上传/下载数据**

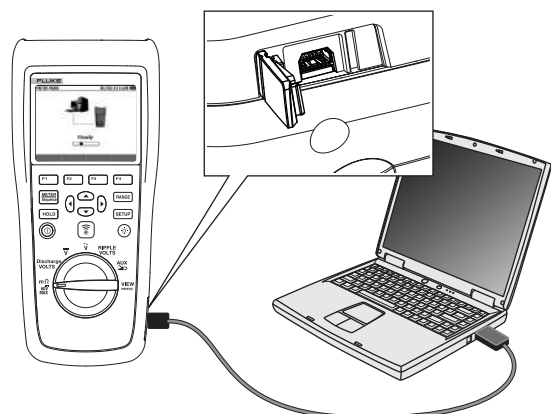

**Charge Battery / 电池充电**

